

MPreC® – Pressure Relief Device

Order specification sheet

Messko



MPreC®-Series

LARGE MESSKO PRESSURE RELIEF DEVICE

Complete the Order-N° by choosing the specific add-on's:

e.g.: LMPRD 685-08-22-N01-00

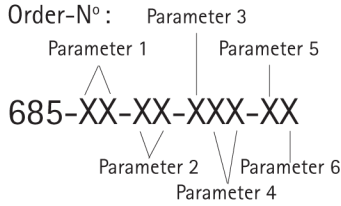

XX	Operating pressure
Parameter 1	
<input type="checkbox"/>	04 4psi; 0.28bar (28kPa)
<input type="checkbox"/>	05 5psi; 0.35bar (35kPa)
<input type="checkbox"/>	06 6psi; 0.41bar (41kPa)
<input type="checkbox"/>	08 8psi; 0.55bar (55kPa)
<input type="checkbox"/>	10 10psi; 0.69bar (69kPa)
<input type="checkbox"/>	12 12psi; 0.83bar (83kPa)
<input type="checkbox"/>	15 15psi; 1.03bar (103kPa)
<input type="checkbox"/>	20 20psi; 1.38bar (138kPa)
<input type="checkbox"/>	25 25psi; 1.72bar (172kPa)
<input type="checkbox"/>	30 30psi; 2.07bar (207kPa)

XX	Electrical connection
Parameter 2	
<input type="checkbox"/>	00 No micro-switches or cable glands
<input type="checkbox"/>	11 Cable gland connection: 1x M20x1.5 1 micro-switch,
<input type="checkbox"/>	12 Cable gland connection: 2x M20x1.5 2 micro-switches,
<input type="checkbox"/>	21 Terminal box: 1 cable gland M25x1.5 1 micro-switch,
<input type="checkbox"/>	22 Terminal box: 2 cable glands M25x1.5 2 micro-switches,
<input type="checkbox"/>	31 ANSI connector: 1 micro-switch
<input type="checkbox"/>	32 ANSI connector: 2 micro-switches
<input type="checkbox"/>	41 Westinghouse connector: 1 micro-switch with grounding
<input type="checkbox"/>	43 Westinghouse connector: 1 micro-switch without grounding
<input type="checkbox"/>	44 Westinghouse connector: 2 micro-switches without grounding

Device identification:

LMPRD - [] [] psi

Order-N°:

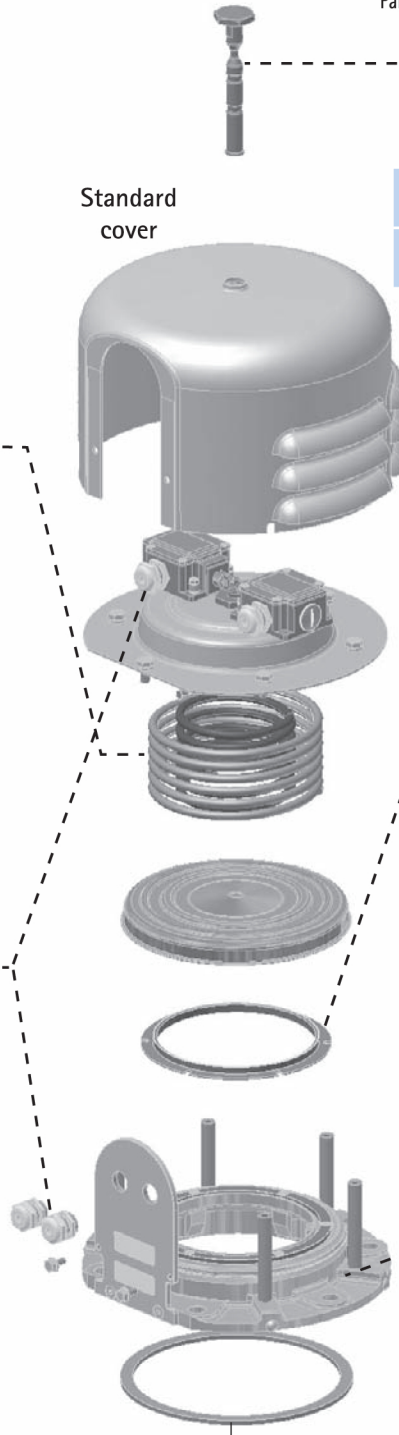

Standard cover

X	Gasket material	Pin indicator color	Transformer fluid type
Parameter 3			
<input type="checkbox"/>	N Nitrile (standard)	<=> Red	<=> Mineral oil
<input type="checkbox"/>	V Viton	<=> Blue	<=> Silicon, Pyranol

XX	Cover
Parameter 4	
<input type="checkbox"/>	00 Standard cover color RAL 7033*
<input type="checkbox"/>	01 Standard cover color RAL 7038*
<input type="checkbox"/>	06 Oil-directed cover color RAL 7033*
<input type="checkbox"/>	07 Oil-directed cover color RAL 7038*

*RAL7033 - cement grey
RAL7038 - light grey

Oil-directed cover

X	Bleed screw
Parameter 5	
<input type="checkbox"/>	0 Yes (standard)
<input type="checkbox"/>	1 No

X	Semaphore
Parameter 6	
<input type="checkbox"/>	0 No (standard)
<input type="checkbox"/>	1 Yes

Sealing gaskets upon request
Nitrile Order No. 960729
Viton Order No. 211470